

Revised: 2016-09-19

User Manual Exos Pin Bone Removers



Thank you for choosing a hand held Pin Bone remover from Exos. We hope you will find a tool that gives you the speed, yield and efficiency that you expect from a professional company.

When you rinse the equipment often and keep it clear from grease you ensure the equipments possibility to grab the bones. The way you hold and move the machine affects the result of how the bones are pulled out.

This users manual give you advice on how to avoid broken or left bones and gapping.



This user manual is valid for these models:

- Exos-130R
- Exos-130RW
- Exos-130L
- Exos-130LW

- Exos-221R
- Exos-221RW
- Exos-221L
- Exos-221LW



Manufactures declaration of conformity

As manufacturer, we declare that the equipment follows the provision of the directives stated below:

- 1 *Manufacturer*
**Exos Sweden AB
Fullerö Ekeby 725
SE-755 94 Uppsala
SWEDEN**

- 2 *Type of equipment*
Pin Bone Remover

- 3 ***EC-directive applied to the product***
 - MD 98/37/EC
 - 93/68EEG
 - EN/IEC61000-6-2 Ed2
 - EN55011 (Group I, Class B)
 - EN 61000-6-4:2001



EXOS-130 SPECIFICATIONS

Weight, handle	500gr
Effect	25W
Voltage	100 – 240 V AC
Frequency	50 – 60 Hz
Motor, brushless	24V DC
Fixed speed	150 rpm
Control box dimensions	190x130x52 mm
Cable length, handle to control box	3 m
Cable length, control box to outlet	1,5m open end

EXOS-221 SPECIFICATIONS

Weight, handle	700gr
Effect	25W
Voltage	100 – 240 V AC
Frequency	50 – 60 Hz
Motor, brushless	24V DC
Variable speed	0 - 200 rpm
Control box dimensions	190x130x70 mm
Cable length, handle to control box	3 m
Cable length, control box to outlet	1,5m open end



Watch out!

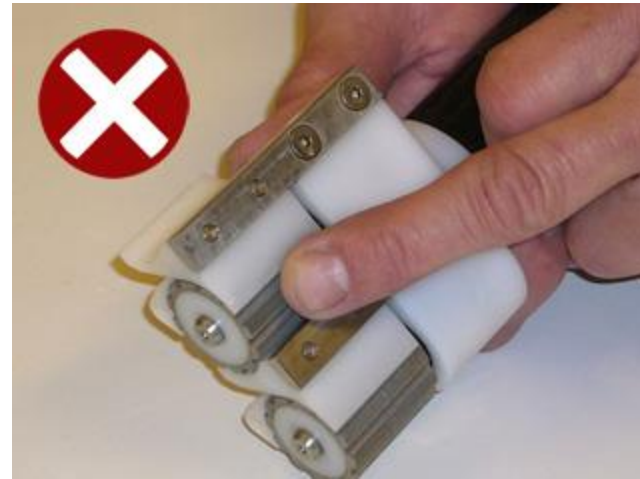
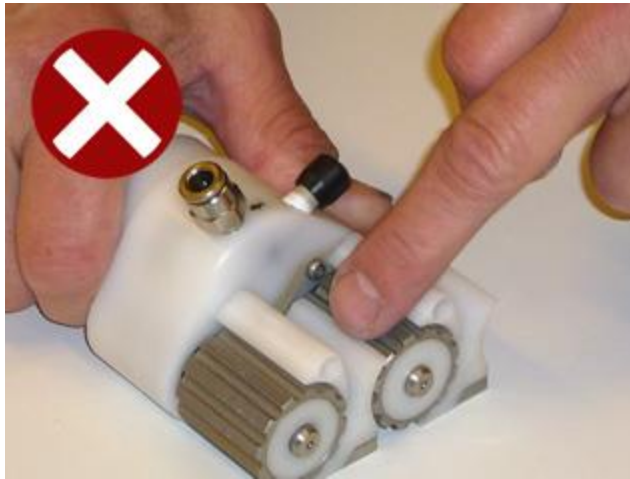

- Never put your fingers close to the drums while working



Install the water

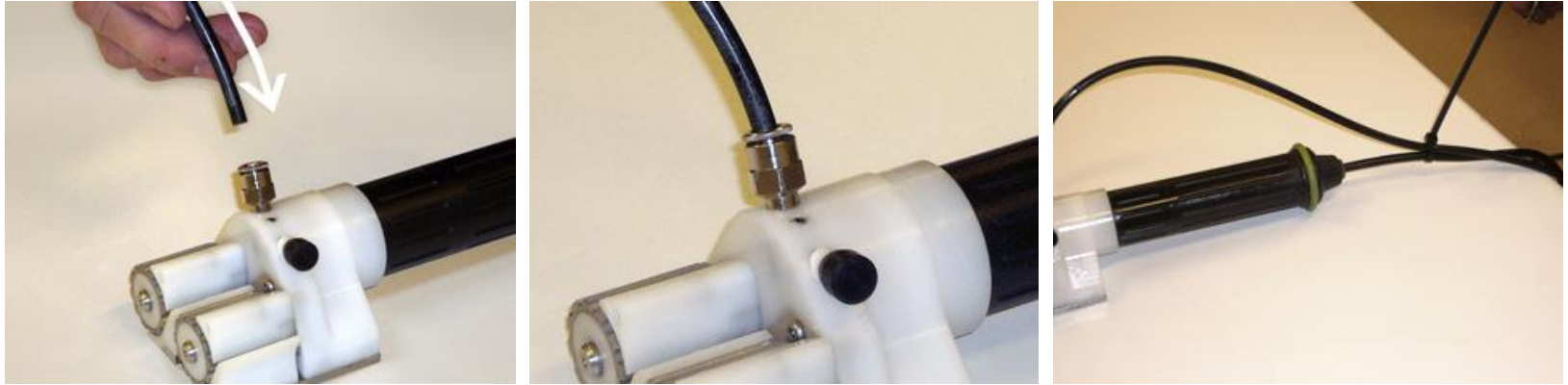

- Push the water hose into the water connector
- Tie the water hose and the electrical cable together

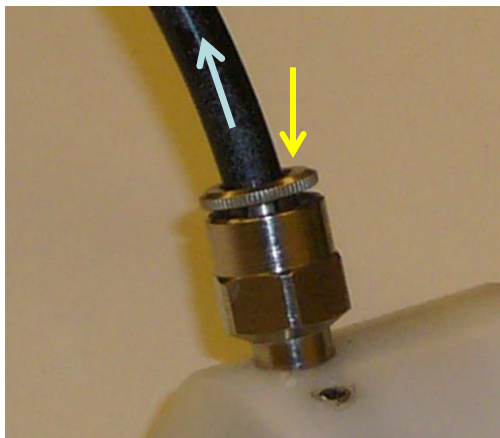

- To disconnect the water hose, press the chrome ring down, while pulling the tube out.



Placing the fillet right

- In order to work most efficient, place the fillet with its head closest to you
- You can then push or hold back the equipment with little risk of imbalance

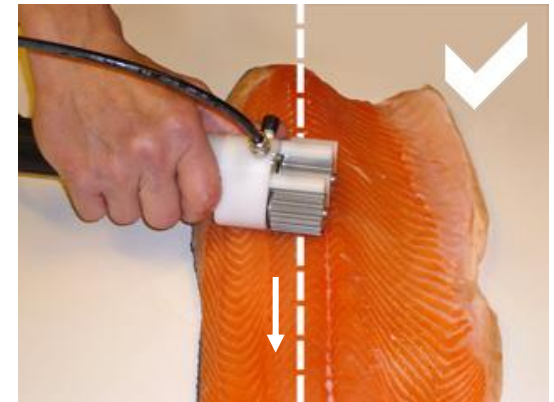

Raising the bones

- Use the bone guide holder if you want to put up the end of the bones
- Slant the machine so that only the bone guide holder touches the fish
- Press down and move your hand towards the tail
- This makes it easier to get hold of the bones with little pressure on the machine



Placing the machine correct (1)

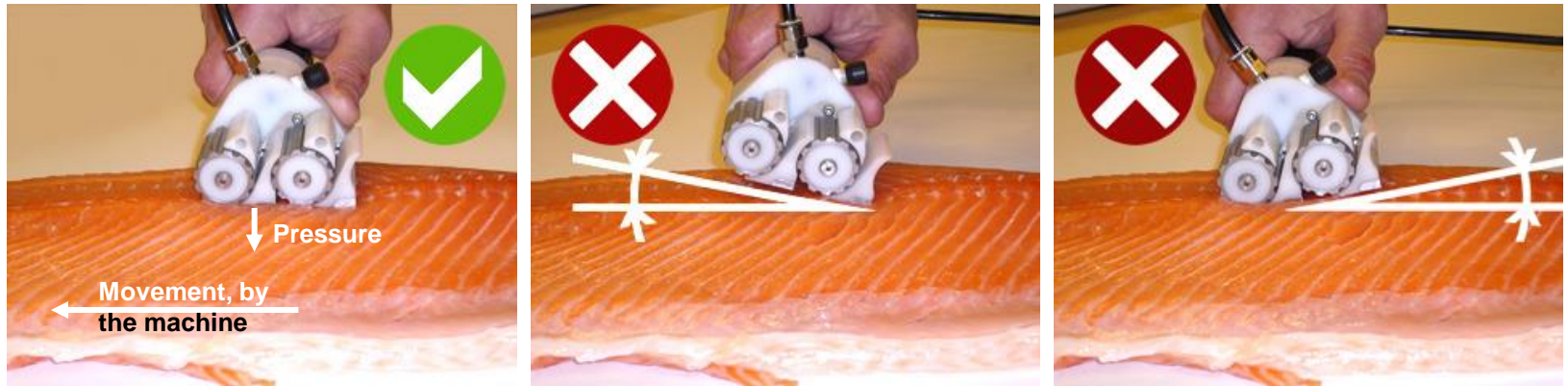

- Make sure the whole area of the machine touches the fish
- Press downwards
- Let the machine move by itself over the fillet. Do not push it forward!
- An uneven pressure can cause an incorrect angle. Missed bones or gapping may occur



Placing the machine correct (2)

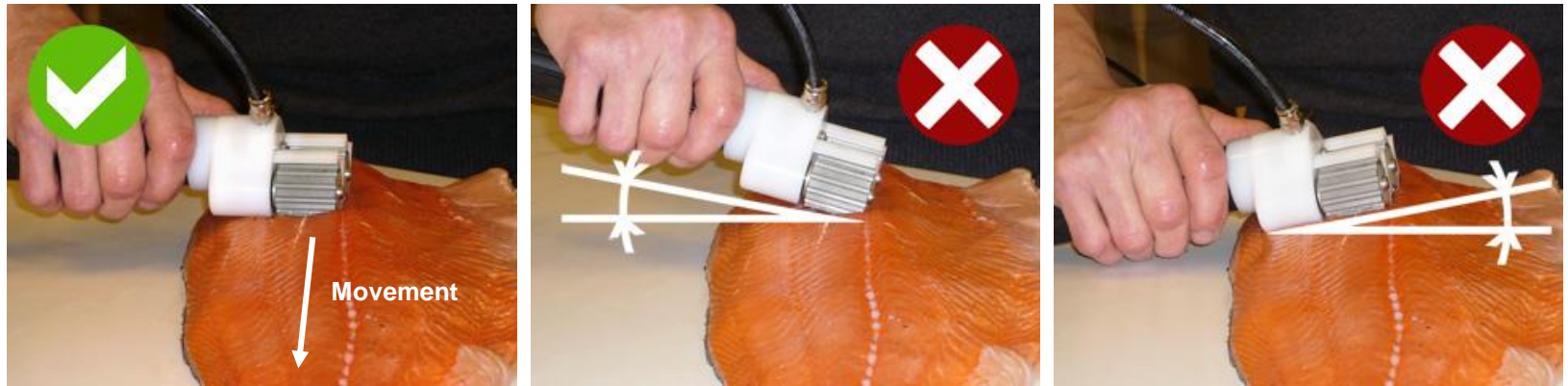

- Make sure the whole area of the machine touches the fish and press while moving the machine over the fish
- Twisting the machine forward or backward may cause gapping or missed bones



Placing the machine correct (3)

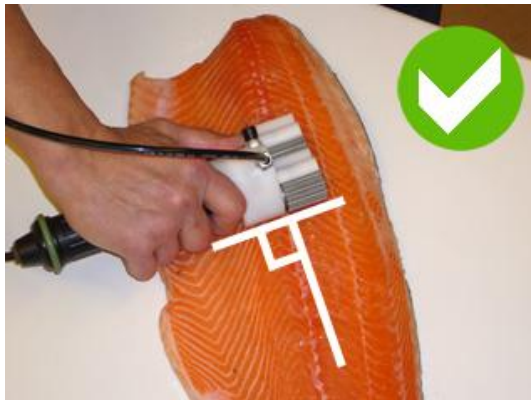
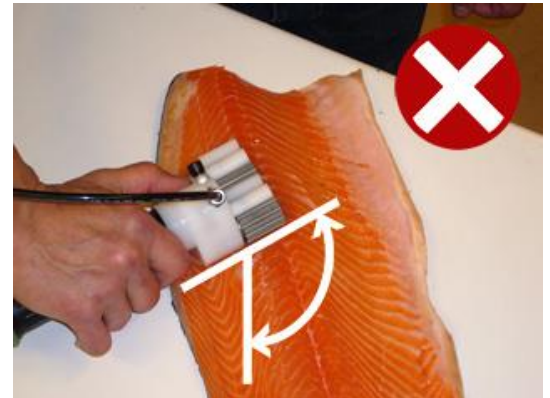
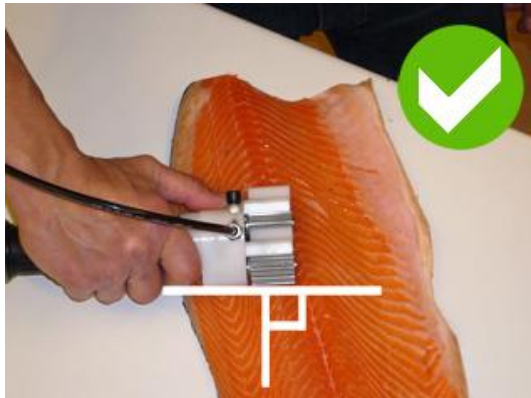

- Always strive to get the drum 90° towards the bone so you can pull it out in the same direction as its fitted in the fish. An incorrect angle may cause gapping
- Turn the machine clockwise on a left fillet and anti-clockwise on a right fillet



Speed and movement

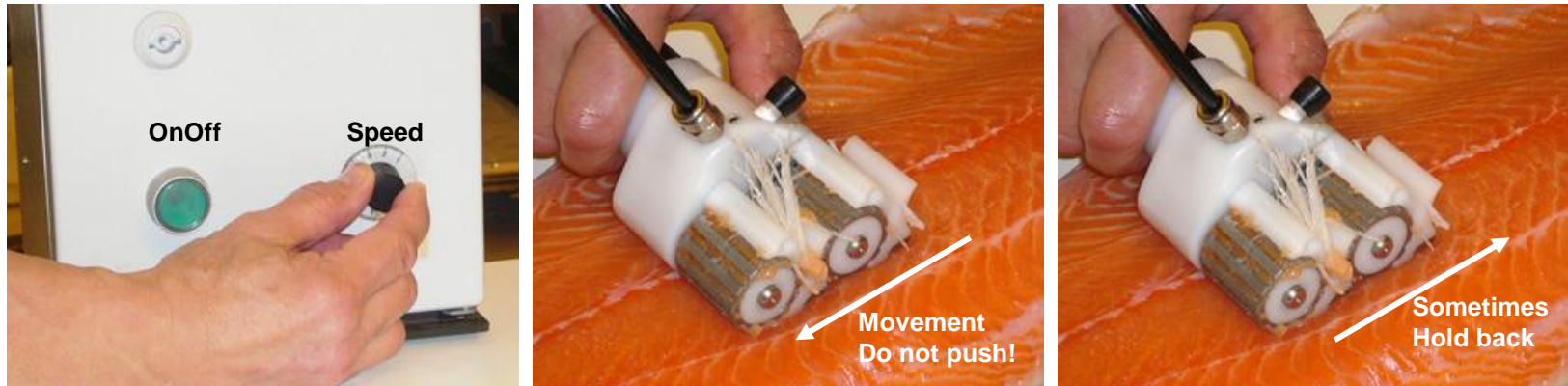

- Start using a low speed, and pin bone the first fillet. Increase speed as long as the result is satisfying*
- Do not push the machine forward – let the drums move over the fillet in its own speed. If you push you might get broken bones or gapping
- When bones are hard to get out, you might have to “hold the machine back” until you feel that the bone is grabbed and fed into the machine



* Only valid for Exos-221

Pull out the neckbones



- Lift up the fillet and pull the neckbones out
- Strive to pull the bones out in its own direction in order to avoid broken bones
- You can press deep in the fish
- Mind your fingers!



Rinsing the equipment regularly



- When the machine is full of bones or grease turn the machine away from the fish and press the water device
- If bones are stuck; try flush more often – or – try flush less often: bones from underneath may press up the stuck bones



Cleaning the equipment after use

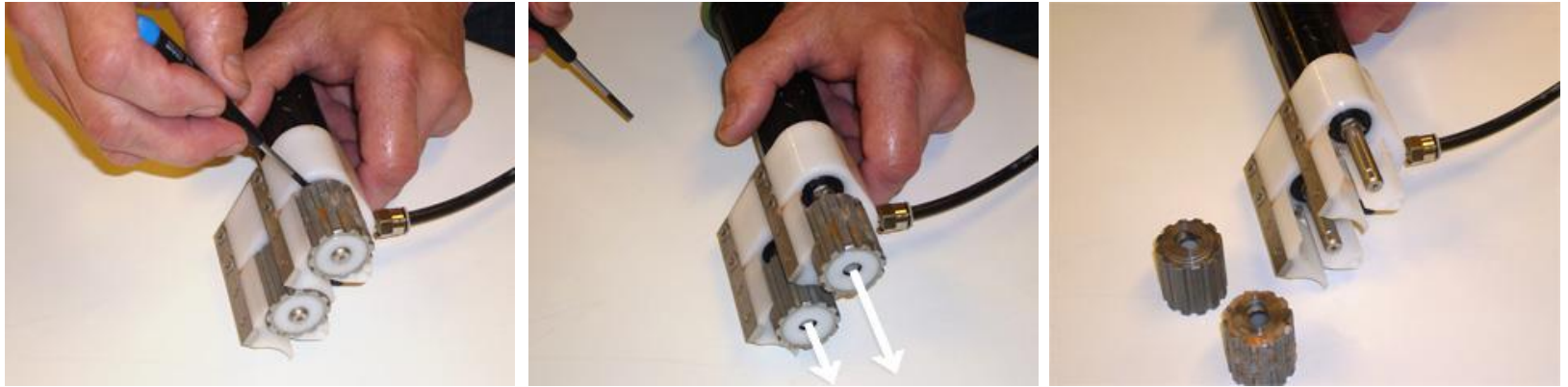

- Use your fingers or tool to remove the drums



Cleaning the equipment after use



- Press the boneguide in order to remove it
- Clean all parts
- NOTE! Do NOT submerge the machine in water
- Assemble in the reverse direction





Exos Sweden AB, Uppsala, Sweden
WWW.EXOS.SE